

Jatco/Nissan JF015E (RE0F11A)

These parts also fit Mitsubishi F1CJB.

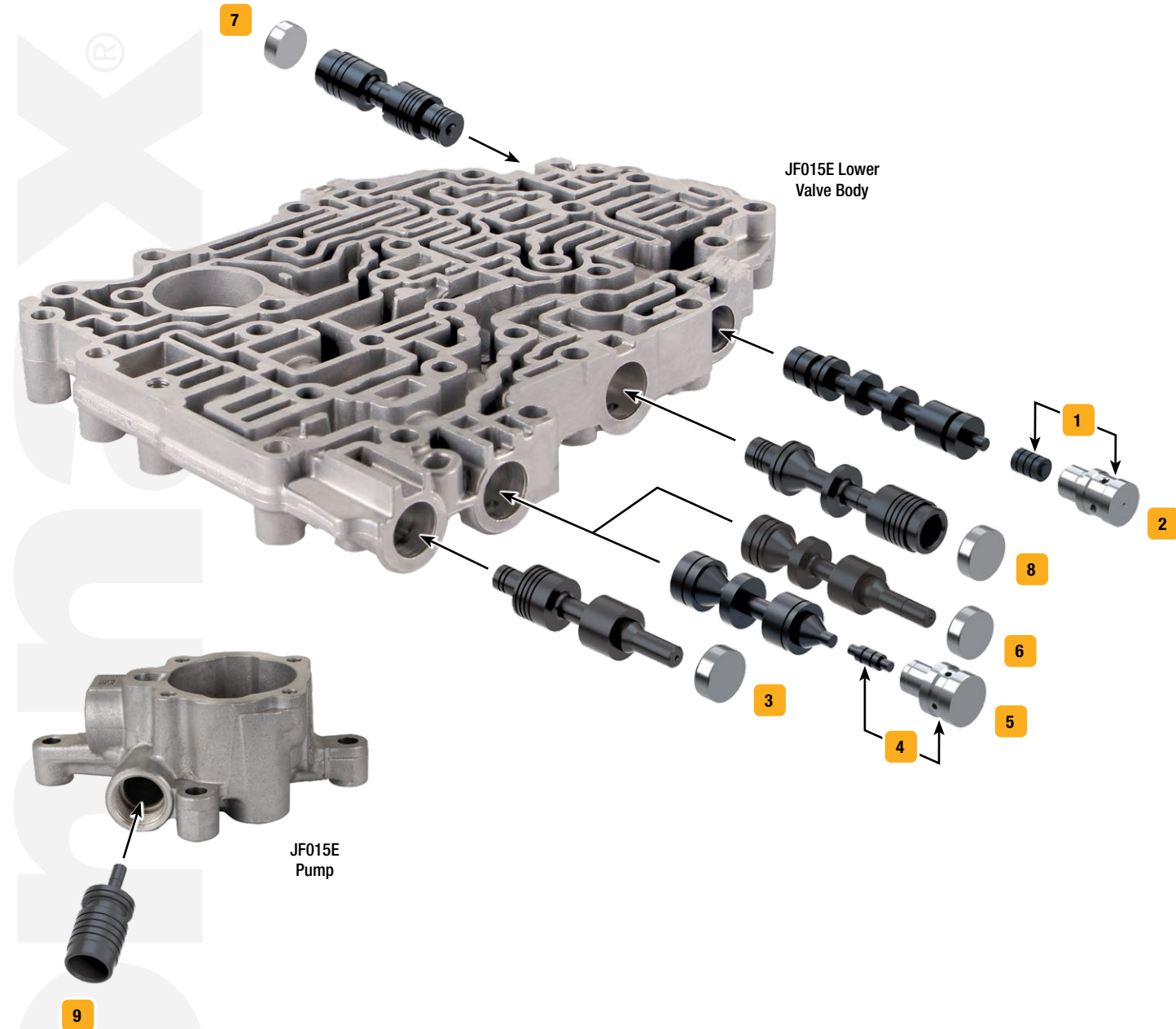

sonnax®

Click on part numbers for product details or visit www.sonnax.com to see all products for the unit(s) shown here.

Symptoms/Part Type	Product Name	Part No.	Details	ZIP Drop-In Zip Valve™ Parts	Tooling
TCC/Lockup Symptoms					
Jerking on coastdown, High engine RPM, Engine stall on engagement, No lockup	Lockup Control Plunger Valve Kit	1 113741-11K	ZIP		
Jerking on coastdown, Harsh engagement, High engine RPM, No lockup	Oversized Lockup Control & Plunger Valve Kit	2 33741F-09K			F-33741F-TL9*
Chatter on acceleration, Noise on acceleration, Push belt slippage, Low line rise	Oversized Solenoid Regulator Valve Kit	3 33741F-03K			F-33741F-TL3*
Engine stall on engagement, Increased RPM during acceleration, No lockup, Overheated fluid	Torque Converter Lube Regulator Plunger Valve Kit	4 33741F-07K	ZIP	For valve assemblies with plunger valve & sleeve	
	Oversized Torque Converter Lube Regulator & Plunger Valve Kit	5 33741F-05K		For valve assemblies with plunger valve & sleeve	F-33741F-TL4*
	Oversized Torque Converter Lube Regulator Valve Kit	6 33741F-04K		For valve assemblies without plunger valve & sleeve	F-33741F-TL4*
Pressure Problems					
Chatter on acceleration, Damaged valve body casting, High line pressure, Low line pressure	Oversized Primary Pulley Regulator Valve Kit	7 33741F-02K			F-33741F-TL2*
Push belt slippage, Pulley breakage, RPM surge, Chatter on acceleration	Oversized Secondary Pulley/Pressure Regulator Valve Kit	8 33741F-01K			F-33741F-TL*
Shift/Engagement Concerns					
Push belt slippage, Delayed engagement, Low pump volume	Pump Flow Control Valve	9 33510N-02	ZIP	'07-Later	
	Oversized Pump Flow Control Valve	9 33510N-01		'07-Later	F-33510N-TL*

* VB-FIX Required